

SIRIO



4 ANNI DI GARANZIA
4 YEARS WARRANTY

MADE
in **ITALY**

EuLux
ILLUMINAZIONE A LED

SIRIO



I SIRIO sono faretti tecnico-decorativi ad incasso per esterno. La gamma comprende sia segnapassi ad incasso a pavimento e sia segnapassi ad incasso a muro. I SIRIO sono disponibili in diversi colori per un' illuminazione d'accenti precisa ed efficace.

The SIRIO are technical and decorative recessed spotlights for outdoor use. The range includes both in-ground and wall lighting. The SIRIO are available in different colors and chromaticity for a precise and efficient lighting accents.

Struttura: Body:	Realizzata in pressofusione di alluminio a basso contenuto di rame. Injected Alu with low content of copper.
Alimentazione e IP: Input power and IP:	12Vdc, IP67; 12Vdc, IP67;
Colore luce disponibili	Bianco 5000K (a scelta: 3000, 4000 o 6000K); White 5000K (choice: 3000, 4000 or 6000K): oppure singolo colore Rosso, Verde, Blu e RGB;
Durata ed efficienza LED: Lifetime and efficiency:	60000h 150lm/W (led CREE oppure NICHIA); 60000h 150lm/W (Led CREE or NICHIA);
Temperature di contatto: Contact temperatures:	< 45°; < 45°;
Ottiche: Optical:	Simmetriche ed asimmetriche su tutti i modelli; Symmetric and asymmetric on all models;
Resistenza al carico statico: Resistance to static weight	500/1000 Kg. 500/1000 Kg.
Resistenza agli urti Impact resistance:	IK08; IK08;

Norme di riferimento: EN 60598-1, EN62471, EN55015, EN61547, EN61000-3-2, EN61000-3-3, UNI EN 12464-1.
Direttive: 2011/65/CE, 2006/95/CE, 204/108/CE.

Reference standards: EN 60598-1, EN62471, EN55015, EN61547, EN61000-3-2, EN61000-3-3, UNI EN 12464-1

Guidelines: 2011/65/CE, 2006/95/CE, 204/108/CE.



SIRIO_ONE

FOTOMETRICA - *PHOTOMETRIC*

DIMENSIONE - *DIMENSION*

(*asymmetric*)

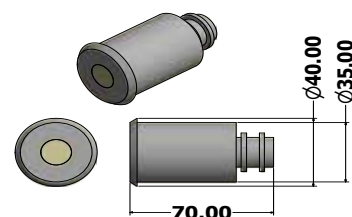
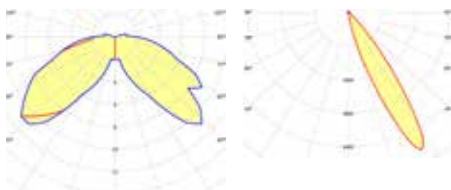

2W, 1 Led, 300lm (eq. alog. 20W), Apert. fascio 45° (anche asimmetrico)
2W, 1 Led led 300lm (eq. Halogen 20W), 45° Beam angle (also asymmetric)

SIRIO411-R

FOTOMETRICA - *PHOTOMETRIC*

DIMENSIONE - *DIMENSION*

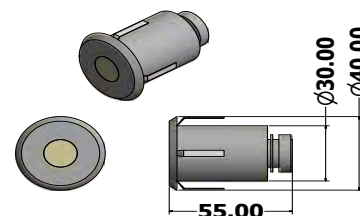
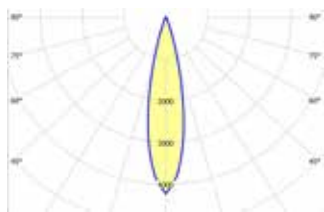

2W, 1 Led, 300lm (eq. Alogeno 10W), Aper. Fascio 30°, 45° e 60°, IP54
2W, 1 led 300lm (eq. Halogen 10W), 30°, 45° e 60° Beam angle, IP54

SIRIO411-Q

FOTOMETRICA - *PHOTOMETRIC*

DIMENSIONE - *DIMENSION*

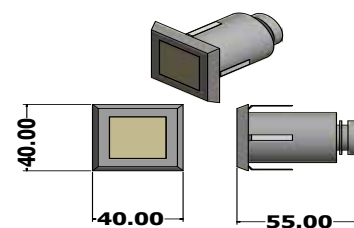
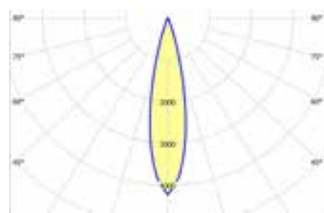

2W, 1 Led, 300lm (eq. Alogeno 10W), Aper. Fascio 30°, 45° e 60°, IP54
2W, 1 led 300lm (eq. Halogen 10W), 30°, 45° e 60° Beam angle, IP54

SIRIO001

FOTOMETRICA - *PHOTOMETRIC*

DIMENSIONE - *DIMENSION*

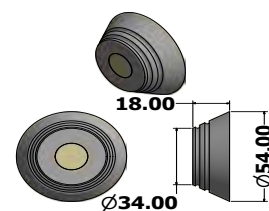
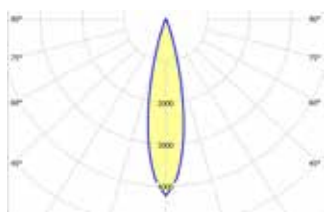

2W, 1 Led, 300lm (eq. Alogeno 10W), Aper. Fascio 30°, 45° e 60°, IP54
2W, 1 led 300lm (eq. Halogen 10W), 30°, 45° e 60° Beam angle, IP54

SIRIO003



FOTOMETRICA - *PHOTOMETRIC*

DIMENSIONE - *DIMENSION*

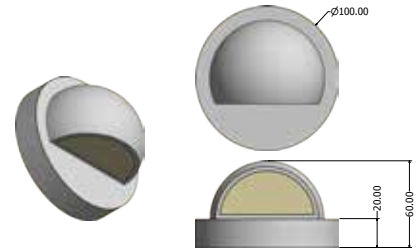
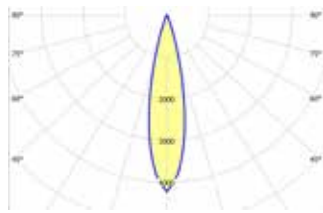

5W, 3Led, 750lm (eq. Alogeno 50W), IP54
5W, 3led 750lm (eq. Halogen 50W), IP54

SIRIO002



FOTOMETRICA - *PHOTOMETRIC*

DIMENSIONE - *DIMENSION*

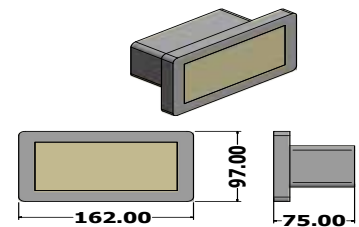

8W, 4 led, 1200lm (eq. Alogeno 50W), Aper. Fascio 180°, IP65
8W, 4 led 1200lm (eq. Halogen 50W), 180° Beam angle, IP65

SIRIO043



FOTOMETRICA - *PHOTOMETRIC*

DIMENSIONE - *DIMENSION*

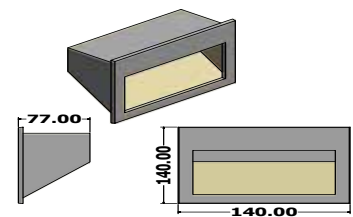
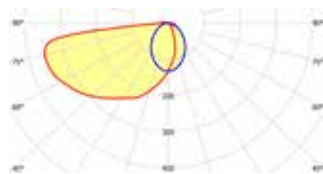

5W, 3 led, 750lm (eq. Alog. 70W), IP65
5W, 3 led, 750lm (eq. Halogen 70W), IP65

SIRIO046



FOTOMETRICA - *PHOTOMETRIC*

DIMENSIONE - *DIMENSION*

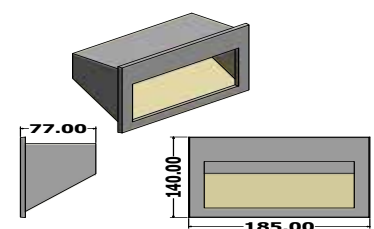
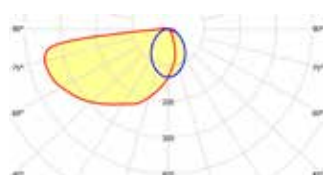

10W, 4 led, 1500lm (eq. Alog. 150W), IP65
10W, 4 led 1500lm (eq. Halogen 150W), IP65

SIRIO033



FOTOMETRICA - *PHOTOMETRIC*

(asymmetric)



DIMENSIONE - *DIMENSION*

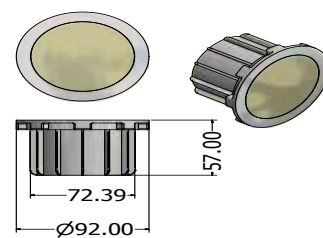

10W, 4Led, 1500lm (eq. alog.100W), Aper.fascio 45° e 60° (pure asimmet)
 10W, 4Led, 1500lm (eq. Halogen 100W), 45° Beam angle (also asymmetric)

SIRIO033_RGB



FOTOMETRICA - *PHOTOMETRIC*

(asymmetric)



DIMENSIONE - *DIMENSION*

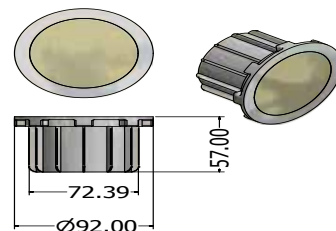

8W, 4Led **RGB**, Aper.fascio 30° e 60° (pure asimmetrico)
 8W, 4Led, **RGB**, 45° or 60° Beam angle (also asymmetric)

SIRIO63



FOTOMETRICA - *PHOTOMETRIC*

(asymmetric)



DIMENSIONE - *DIMENSION*

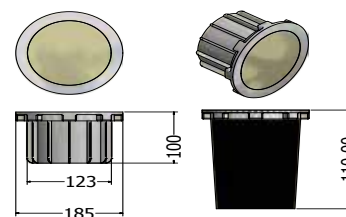

20W, 8Led, 3000lm (eq. alog.200W), Aper.fascio 45° e 60° (pure asimmet)
 20W, 6Led 3000lm (eq. Halogen 200W), 45° Beam angle, (also asymmetric)

SIRIO63_RGB



FOTOMETRICA - *PHOTOMETRIC*

(asymmetric)



DIMENSIONE - *DIMENSION*

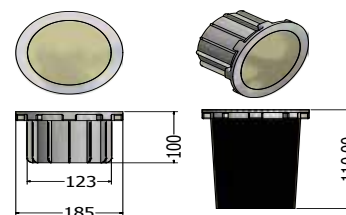

16W, 8Led **RGB**, Aper.fascio 30° e 60° (pure asimmetrico)
 16W, 8Led, **RGB**, 45° or 60° Beam angle (also asymmetric)

SIRIO69

FOTOMETRICA - *PHOTOMETRIC*

DIMENSIONE - *DIMENSION*

(*asymmetric*)

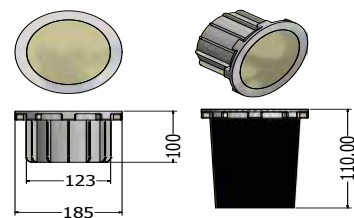

30watt, 12Led, 4500lm (eq. alog.300w), Aper.fascio 45° e 60°(pure asim.)
 30watt, 12Led 4500lm (eq. Halogen 150w), 45° Beam angle, (also asymmetric)

SIRIO069_RGB

FOTOMETRICA - *PHOTOMETRIC*

DIMENSIONE - *DIMENSION*

(*asymmetric*)

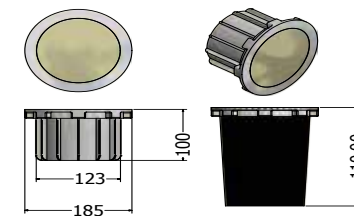

24W, 12Led RGB, Aper.fascio 30° e 60° (pure asimmetrico)
 24W, 12Led, RGB, 45° or 60° Beam angle (also asymmetric)

SIRIO23-1

FOTOMETRICA - *PHOTOMETRIC*

DIMENSIONE - *DIMENSION*

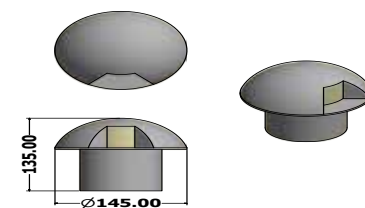
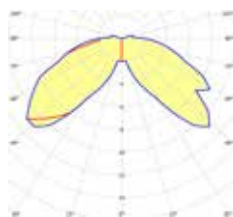

3W, 1 led, 450lm (eq. Alog. 25W), Aper. fascio asimmetrico su un lato
 3W, 1 led, 450lm (eq. Halogen 25W), Beam angle asymmetrically on one side

SIRIO23-4

FOTOMETRICA - *PHOTOMETRIC*

DIMENSIONE - *DIMENSION*

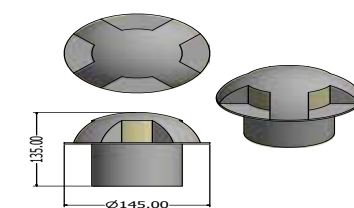
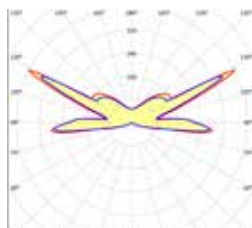

12W, 4 led, 1800lm (eq. Alog. 100W), Aper. fascio asimmetrico su 4 lati
 12W, 4led 1800lm (eq. Halogen 100W), Beam angle asymmetrically on 4 sides